



**ADDENDUM #1**

August 3, 2010  
Bowie State University's Bidder's List  
IFB #BSU 2011-01 McKeldin Gymnasium Roof Replacement

Ladies & Gentlemen:

Addendum number one (1) for IFB #BSU 2011-01 McKeldin Gymnasium Roof Replacement is enclosed for your information and action.

All bidders shall sign and return the addendum, as acknowledgment of receipt. The addendum must be returned as part of each bidder's bid, in lieu of returning it separately.

Please advise immediately if any of the pages of the addendum are missing. Please acknowledge receipt of the addendum by signing and returning it with your bid. Failure to do so may be cause for rejection of your bid.

Sincerely,

A handwritten signature in blue ink, appearing to read 'Steven A. Jost', is written over the printed name and title.

Steven A. Jost  
Director of Procurement

\_\_\_\_\_  
Signature

\_\_\_\_\_  
Title

\_\_\_\_\_  
Company Name

\_\_\_\_\_  
Date

**ADDENDUM #1**  
**IFB #BSU 2011-01, MCKELDIN GYMNASIUM ROOF**  
**REPLACEMENT**

The question below was received by Bowie State University prior to the deadline for questions and inquiries of July 29, 2010. We will not be responding to questions received after the deadline.

The question and the answer provided below are now incorporated into and become a part of the original solicitation document.

In the event of any conflict, the answers provide in Addendum #1 supersede any information provided in the original solicitation document.

The University has responded the questions below to the best of our capability at this time. We will not respond to any follow-up questions or clarifications to the answers provided herein. This Addendum shall be the final communication regarding IFB #BSU 2011-01, until after the bids have been received and evaluated.

**Question:**

1. Drawing says vapor barrier at shingle deck per Sec 07260 that section is not in specifications. Drawing says copper gutters, spec says aluminum concealed bracket is ambiguous – no metal clarification for shingle flashings – please clarify.

**Answer:**

This was a typo, section reference is 07620. All Gutters and Downspouts shall be Copper; all Concealed Brackets shall be Copper and shall be installed per spacing on the drawings in an approved sturdy installation. As per Specifications, Section 07312.2.10 shall all be copper.

**Addition:**

Attached and made a part of this IFB is drawing sheet A802, an addition to the 'BID SET ISSUE' drawings. This sheet will be an addition to the sheets already in the set that is posted for bids.

Sheet A802, details and specifies a substitute 'NAILBASE INSULATION' for the sloping/shingle section of the roof and is necessary for the pricing in the bid as concealed conditions may require the use of this product.

It is a Bid-Alternate to be used in lieu of the insulation called for in the 'BID-SET ISSUE'.

**Revision:**

Please use Revised Bid Tabulation Forms below.

**SECTION VI. BID TABULATION FORM**

Contractor Name \_\_\_\_\_

Pursuant to and in compliance with your Invitation for Bids, dated \_\_\_\_\_, and other documents relating thereto, the undersigned hereby proposes to provide all labor, materials, equipment, and supervision necessary for complete Replacement of the Theodore McKeldin Gymnasium Roof as required by and in strict accordance with the contract documents, schedules, specifications, and drawings and on which this Bid is based, including:

Addendum No. \_\_\_\_\_ Dated \_\_\_\_\_

Roof System Manufacturer: \_\_\_\_\_

**A. Lump Sum Cost With Allowances**

<b>Task</b>	<b>Cost</b>	<b>Schedule (Days)</b>
1. Lump Sum Price – McKeldin Gym Roof Replacement	\$	
2. Material Allowance # 1: Asbestos Abatement and Inspection	\$ 6,000.00	
3. Material Allowance # 2: Lead Abatement and Inspection	\$ 2,000.00	
<b>Total</b>	<b>\$</b>	

**B. Provide alternate costs. These amounts are not to be included in the Lump Sum Costs as presented above.**

<b>Task</b>	<b>Cost</b>	<b>Schedule (Days)</b>
1. Delete all plumbing work associated with removal and replacement of existing roof drains at flat roof areas that are being replaced.	\$	
2. Delete all work associated with the removal and replacement of the existing 1" insulation board below existing shingle roofing systems that are being replaced.	\$	

3. Delete all carpentry work associated with the removal and replacement of wood fascia, soffit boards and trims at the eaves of the existing shingle roofing systems that are being replaced.	\$	
4. Provide an Alternate price for a substitute 'NAILBASE INSULATION' as identified on sheet A802.	\$	

**C. The undersigned intends that the surety company, shall furnish the payment and performance bonds.**

\_\_\_\_\_

\_\_\_\_\_

Full Payment and Performance Bonds - Percentage of Contract Amount	%
--	---

**D. Submit proposed sub-contractor for use, subject to approval by Owner or Architect.**

**Subcontractors**

<b>List all subcontractors</b>	
Demolition (Asbestos Removal)	
Trash Disposal	
Roofing	
Sealant Replacement	
Masonry work	
Electrical Work	
Mechanical Work	
Others:	

I hereby certify that I have thoroughly inspected the project and reviewed the project requirements. I warrant that other than those previously provided, in writing, to the Owner or Engineer, I/we found no errors, inconsistencies, or omissions in the project requirements. The prices provided above are for performing the work in full compliance with the specification. All prices include overhead, profit and all other costs (of whatever nature and character) to complete the work.

The Owner reserves the right to negotiate or reject any costs, which the Owners consider excessive or unreasonable. The Owner at any time may order an increase or decrease in

the quantities applicable to unit prices and the total cost for this work will be based on the agreed unit price and the net (total) quantities required.

The Owner may request additional prices throughout the contract as deemed necessary to meet the project requirements. The Contractor shall supply such prices within three (3) business days after receipt of the request. Such prices shall apply after they are incorporated into the Contract.

The Owner reserves the right to reject any or all proposals and waive informalities. The Owner also reserve the right to select manufacturer(s) based upon warranties provided by the manufacturer, finished appearance, available options, and/or any other factor(s) deemed relevant. The Contractor shall, within three (3) business days after receipt of request, submit information, samples, etc. needed so Owner can decide upon the manufacturer(s) to be used.

I certify that my company is a (corporation), (partnership), (sole owner) licensed to do business in the State of Maryland.

---

FIRM NAME

---

CONTRACTOR'S LICENSE NUMBER

---

SIGNATURE

---

PRINTED NAME

---

TITLE

---

DATE

---

PHONE NUMBER

---

EMAIL ADDRESS

**ALTERNATE #4 NAILBASE INSULATION**

**SECTION 07211 ALTERNATE RIGID INSULATION**  
**ACFoam Nailbase Specifications**

**PART 1 GENERAL**

**1.01 SECTION INCLUDES**

- A. HCFC FREE Polyiso Rigid board type roof insulation(s) for thermal protection as part of roofing assemblies.
- B. Recover board Polyiso roof insulation.
- C. Roofing crickets.

**1.02 RELATED SECTIONS**

- A. Section 06500 - Metal Fabrications.
- B. Section 06100 - Rough Carpentry
- C. Section 07311 - Asphalt Shingles
- D. Section 07600 - Sheet Metal Flashing and Trim

**1.03 REFERENCES**

- A. ASTM C 1289 - Standard Specification for Faced Rigid Cellular Polyisocyanurate Insulation Board.
- C. ASTM E 108 - Standard Test Methods for Fire Tests of Roof Coverings.
- D. ASTM E 119 - Standard Test Methods for Fire Tests of Building Construction and Materials.
- F. FM 4470 - Approval Standard - Class I Roof Covers.
- J. ULTR - Long Term Thermal Resistance predicted by CAN/ULC-S770-03.
- L. UL 790 - Standard Test Methods for Fire Tests of Roof Coverings.

**1.04 SUBMITTALS**

- A. Submit under provisions of Section 01 30 00 and 01 60 00.
- B. Product Data:
  - 1. Manufacturer's specifications
  - 2. Installation instructions for insulation board and fasteners
  - 3. Product Data as per ASTM 2129 - 01 Standard for Data Collection for Sustainability Assessment of Building Products
- C. Samples:
  - 1. Submit 6 by 6 inch (152 by 152 mm) samples of each board type required.
  - 2. Submit samples of each fastener type required.
  - D. Shop Drawings: Roof plan showing layout of boards and fastening patterns.
  - E. Certificates: System Manufacturer's or insulation manufacturer's certification that the insulation meets Zero ODP (Ozone Depletion Potential) and Zero GWP (Global Warming Potential) specification requirements.
  - F. Thermal Warranty: Submit sample warranty indicating conditions and limitations.

**1.05 QUALITY ASSURANCE**

- A. Regulatory Requirements:
  - 1. American Society for Testing and Materials (ASTM).
  - 2. Federal Specifications (FS).
  - 3. Factory Mutual (FM).
  - 4. Underwriters Laboratories Inc. (UL) Classification.
  - 5. IBC, BOCA, UBC and SBC Sections on Foam Plastic Insulation.

**1.06 DELIVERY, STORAGE AND HANDLING**

- A. Comply with general requirements specified in Section 01 60 00.
- B. Deliver insulation in packages labeled with material name, thermal value and product code.
- C. When stored outdoors, stack insulation on pallets above ground or roof deck and cover with tarpaulin or other suitable waterproof covering. Silt or remove manufacturer's packaging before covering with waterproof covering.

**1.07 PROJECT CONDITIONS**

- A. Comply with insurance underwriter's requirements applicable for products of this Section.
- B. Do not install insulation on roof deck when water of any type is present. Do not apply roofing materials when substrate is damp or wet.

**PART 2 PRODUCTS**

**2.01 MANUFACTURERS**

- A. Acceptable Manufacturers: Atlas Roofing Corporation, or approved equal.  
Atlas Roofing Corporation,  
2000 River Edge Pkwy, Suite 800, Atlanta, GA 30328.  
Ph. (770) 952-1442  
Fax (770) 952-3170
- B. Provide polyiso roof board insulation from a single manufacturer.

**2.02 MATERIALS**

- A. ACFoam Nail Base: Closed-cell HCFC FREE "Green" polyisocyanurate foam board manufactured using ACUltra Hydrocarbon blowing agent and bonded to 7/16 inch thick APA/TECO rated OSB on the top side and a fiber-reinforced felt facer on the bottom; for use with Asphalt Shingles FM 1-105 and rating, compressive strength - 20 psi.  
ASTM C 1289, Type V  
IBC, NBC, UBC and SBC Sections on Foam Insulation (Chapter 26)  
FMA minimum property requirements  
ARMA insulated deck requirements  
APA/TECO rated OSB nailable surface  
FM Standard 4450/4470 Approval.  
ACFoam Nailbase Insulation is approved for Class 1 insulated roof deck construction. Refer to FM Approval Guide for details.  
UL Standard 790 Classification (ASTM E108)  
For use with Class A, B or C shingles, metal or tile roof coverings.  
UL Standard 263 Fire Resistance Classification (ASTM E119)  
Some classifications for fire resistance are P225, P230, P239, P508, P510, P514, P701, P717, P719, P723, P728, P732, P734, P739, P801, P815, and P819. See UL Fire Resistance Directory.
- B. ULTR - insulation "R" Value: 6.6 Long-term thermal resistance value of the foam were determined in accordance with CAN/ULC-S770. All test samples were third-party selected and tested by an accredited materials testing laboratory.
- C. Related Materials:
  - 1. Fasteners: Factory Mutual approved.
  - 2. Base Ply: As recommended by membrane manufacturer.
  - 3. Fasteners: For Nail Base and Vented-R: Atlas Nail Base Fasteners.
  - 4. Asphalt Blatten: Comply with ASTM D 512, Type II (steep) or Type IV. USE ONLY ON APPROVED BOARD INSULATION

**TYPES**

- a. Provide with labels indicating flash point, softening point, finished blowing temperature, and equiviscous temperature.

**PART 3 - EXECUTION**

**3.01 EXAMINATION**

- A. Examine roof deck for suitability to receive insulation. Verify that substrate is dry, clean and free of foreign material that will damage insulation or impede installation.
- B. Verify that roof drains, supports, roof curbs, nailers, equipment supports, vents and other roof accessories are secured properly and installed in conformance with Contract Drawings and submittals.
- C. Verify that deck is structurally sound to support installers, materials and equipment without damaging or deforming work.

**3.02 APPLICATION / INSTALLATION**

- A. Install specified insulation using approved mechanical fasteners in accordance with manufacturer's latest written instructions and as required by governing codes and Owner's insurance carrier.
- B. Install with end joints staggered to avoid having insulation joints coinciding with joints in deck. In multi-layer installations, stagger joints in top and bottom layers.

**3.03 CLEANING / PROTECTION**

- A. Remove trash and construction debris from insulation surface prior to application of roofing membrane.
- B. Do not leave installed insulation exposed to weather. Cover and waterproof with completed roof system immediately after installation.
  - 1. Temporarily seal exposed insulation edges at the end of each day.
  - 2. Remove and replace installed insulation that has become wet or damaged with new insulation.
- C. Protect installed insulation and roof cover from traffic by use of protective covering materials during and after installation.

**END OF SECTION**

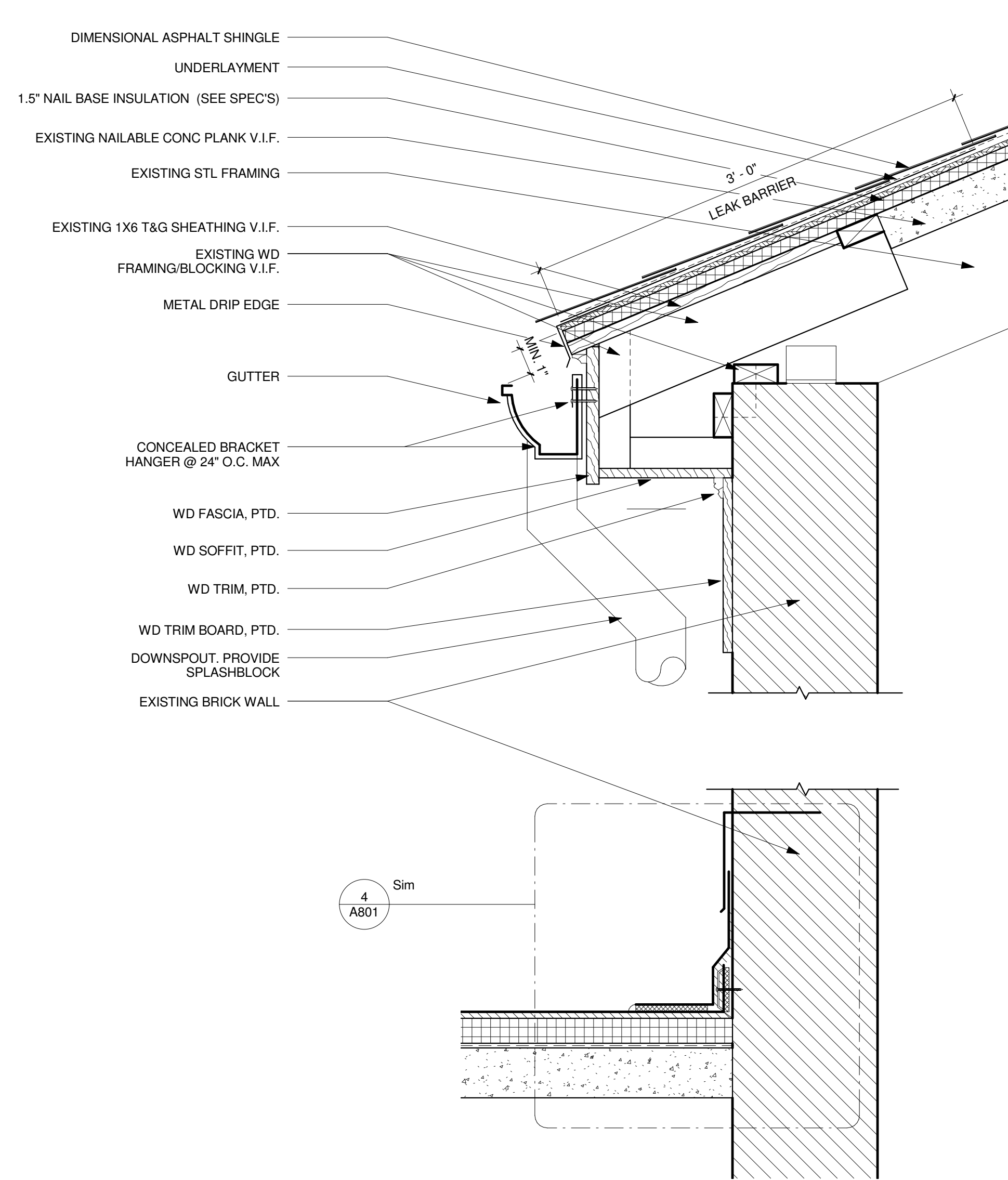

NOTES:  
1. FOR SHINGLE ROOF: ALONG RAKE, PLACE DRIP EDGE ON TOP OF UNDERLAYMENT. ALONG EAVE, PUT UNDERLAYMENT ON TOP OF METAL DROP EDGE.

TYPICAL SECTION @ ROOF/WALL INTERSECTION USING NAIL BASE SUBSTRATE  
1 1/2" = 1'-0"

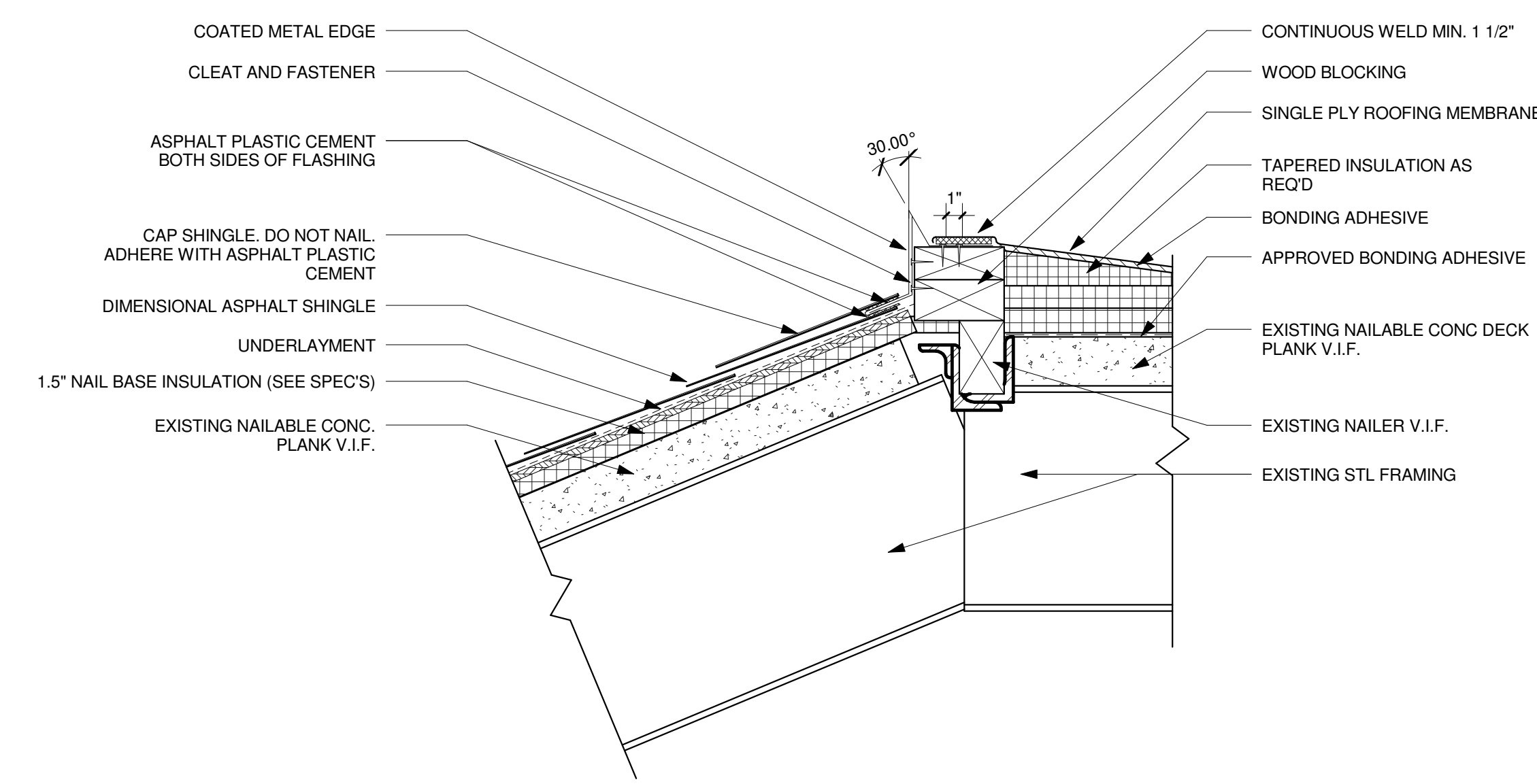

TYPICAL DETAIL @ INTERSECTION OF FLAT AND SLOPED ROOF USING NAIL BASE SUBSTRATE  
2 1/2" = 1'-0"

No.	Date	Description	Revisions
1	07-30-10	ALTERNATE #4 - NAILBASE INSULATION	

engineering consultant



HAMILTON ASSOCIATES LLC  
ARCHITECTURE THAT EVOLVES IDEAS TO CONSTRUCTION  
405 E 8TH STREET BALTIMORE, MD 21202  
240.462.5110 (direct), 202.684.7644 EXT. 1 (cell), 301.464.3463 (fax)  
www.hamiltonassoc.com

SEAL

**SHEET TITLE** PROPOSED DETAILS - ALTERNATE #4 NAILBASE INSULATION  
**PROJECT TITLE** THEODORE MCKELDIN GYMNASIUM ROOF REPLACEMENT  
**ADDENDUM #1** ISSUE, JULY 30, 2010  
BOWIE STATE UNIVERSITY  
14000 JERICHO PARK ROAD  
BOWIE, MD 20715-9405

**CHECKED BY:** JH  
**DRAWN BY:** BH  
**SCALE:** 1/2" = 1'-0"  
**DATE:** 07/30/10

**DRAWING NO:**  
**A802**